

## Wall Mounted Eye Wash (WJH0359D)

### Packing list

Please check the quantity of the fittings according to the following lists after unpacking, check whether there is damage transport, if there is any question or qualitative deficiencies, please get in touch with the local franchiser of our company or our company immediately, you will receive the satisfactory reply.

Number	Name	Quantity
1	Eye Wash sprayer head	1 set
2	Eye wash bowl	1 set
3	Main Body	1 set
4	Wall Mounted Bracket	1 set
5	Switch Push Board	1 set

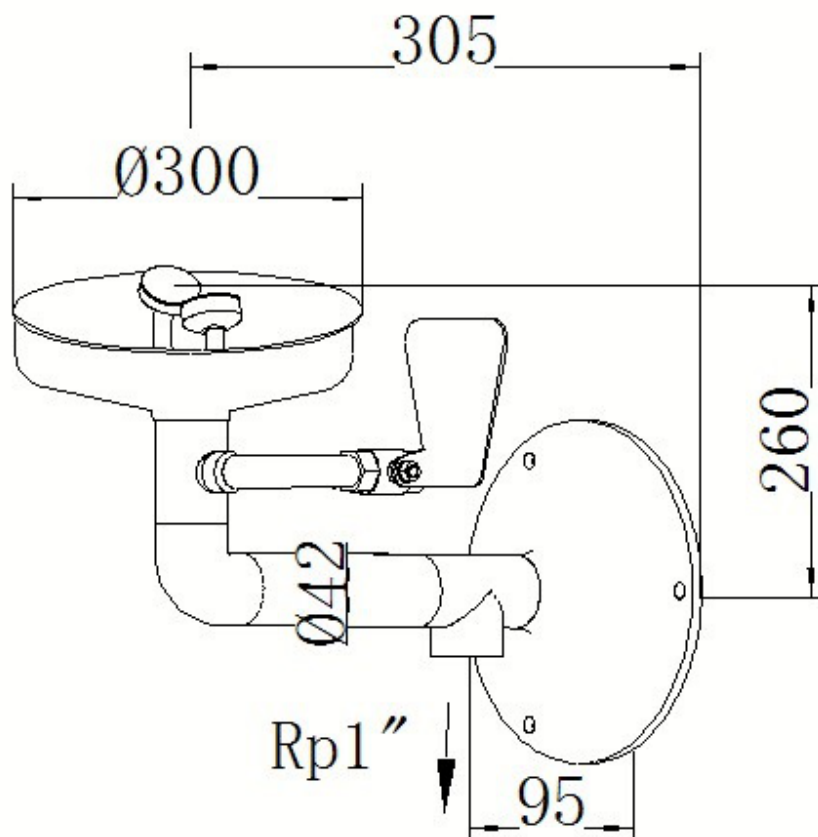

## Operation instruction of the Wall Mounted Eye Wash (WJH0359D)

Welcome to use the product, in order to make you get better security protection, please reading this product manual carefully before use this product.

### \*Using

The emergency eye washer have already been adopted extensively by the most factories and the laboratories of the developed industrial countries of foreign countries, it is the indispensable apparatus of the security and the labors protection. It can make use of reducing the injure of acid, alkali, organic matter and other poisonous corrosive material. It can be extensively apply to petrochemical industry chemical industry, semiconductor industry, medical manufacturing industry, etc.

### \*Defining for eye wash

As the splash of chemical liquid taking place to staff member's body, face, eyes or the staff members' clothes cause the fire, it is the effective safe protection articles to minimize the dangerous.

### \*Main performance parameter

Pressure grade MPa			Flux L/min	Applicable condition
Nominal pressure	Sealed pressure	Working pressure	≥11.4	Pure water of normal atmospheric temperature or according with the sanitary standard
0.4	0.45	0.20~0.40		

The choice of the main performance parameter according to ANSI Z358.1-2014, in order to lighten harmful substance to human skin, eyes injury of top layer and simulate when accidents make happened.

### \*Structure characteristic

1. Making use of the ball valve to control the eye wash. Easy to operate, open and close it fast , it is reliable to close.
2. The flux regulation and control valve can regulate by oneself. (Regulation method can refer to installing and debugging).

### \*Main material:

- 1.The material of main body is 304 SUS stainless steel, with polished surface.
2. Eye wash bowl: 304 stainless steel , green ABS engineering plastics sprayer head

### \*Installing and debugging:

1. Must re-inspect the type of the products, certificate of quality, operation instructions, case the list before installation.
2. The installation site should from within the accident lively to suffer from 15 meter, in order to run 10

second within the place can reach.

3. Recommendations for installation eye wash sprayer head from the ground 838mm-1140mm, the right height for eye wash.
4. Connect the main body and basic bracket, enwind the basin screw with fresh plastic band to connect with water outlet DN and screw well.
5. Installation basic bracket: let the water outlets downwards, adjusts the position of the T-piece and installed it by M10 screw.
6. Connect the water inlet pipeline and water outlet pipeline. Check the switch ball whether is flexible and whether has the block.

### **\*Operation method**

Please push the board clockwise, when you need eye washing, and the eye wash sprayer will work; when pullback the board widdershins, the eye wash sprayer will be shut-off.

### **\*Maintenance**

1. This facility is just used for emergency washing, do not use for shower. Please check the facility according to the rules and regulars. Make sure the facility will work well when there are accidents.
2. Activate shower at least weekly, to ensure the equipment dependability and validity. This equipment can not provide medical treatment; it can just reduce the hurt to the minimum degree by washing.
3. When an accident happens, please decide the showering time according to the hurt and prepare the medical treatment.

### **\*The conk out and solutions**

No.	Conk out	Cause	Solution
1	The shower outlet flux is small	A the diameter of inlet pipe is small B the filter has foreign objects	A change the inlet pipe B remove the foreign objects
2	The eye wash sprayer outlet flux is small	A the adjustment rob is overdo B the adjustment valve is blocked	A turn the rob anti-clockwise B wash the valve
3	The eye wash sprayer outlet flux is large	The adjustment rob is under-do	Turn the rob clockwise
4	The seep in the basin is more	The outlet is blocked	Remove the foreign object